



TECHNOLOGY

GRADMETAL 200

WWW.SUNONBLINDS.COM

SUNON. ESPACIO I LUZ I SOMBRA.



ENGLISH

WHY SUNON BLINDS?

More than 25 years ago, Sunon was born, a company formed by experienced personnel focused on the sector, since January 1993. We stand out for the wide range of solutions we can offer you. Sunon has professional collaborators from various sectors, such as: architects, engineers, window manufacturers, curtain wall manufacturers and builders who provide the right systems for the execution of the project; for this reason, the company is recognized as one of the best in the industry

for the quality of their work. We ensure that in each project, we eliminate any type of openings and gaps, in addition to providing a high-design facade, comfortable, energy-saving, energy, and environmentally friendly. We are specialized in technical and adjustable shutter systems, with dynamic elements for residential sun protection, facades, security, and tunnel boxes, as well as motorization systems. We also take care of product manufacturing, distribution, and installation.

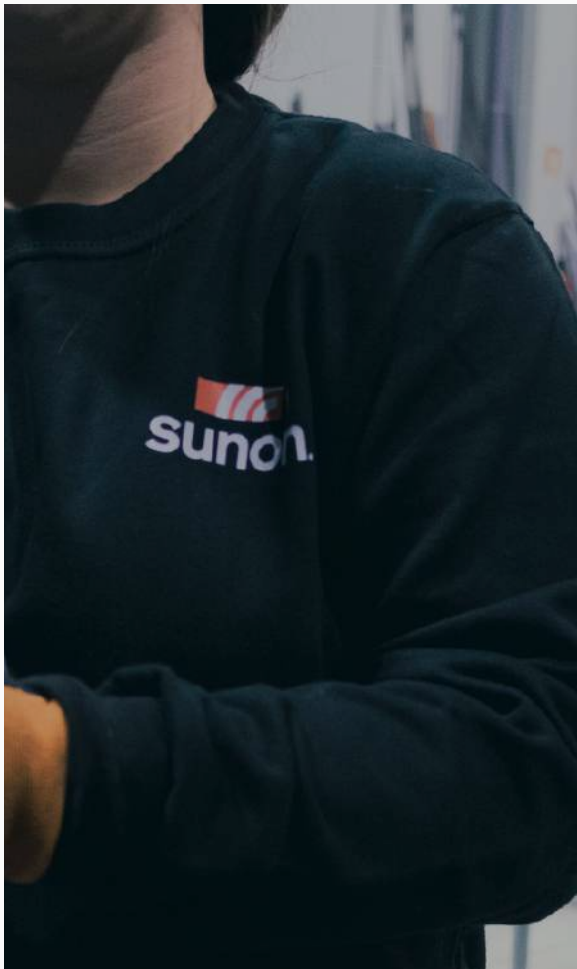

GRADMETAL 200 TECHNOLOGY

Sunon is present in all phases of the project. From advice to architects, to customized solutions for any type of renovation. As a customer, through a virtual test, you can visualize the variety of options according to your project.

We will provide you with a technical and economic study where the total service will be provided, which includes: products, assembly, consulting and after-sales maintenance.

GRADMETAL 200 TECHNOLOGY

HISTORY:

The advantages of SUNON systems allow indoor comfort by transporting natural light, regulating the temperature, avoiding prying eyes from prying eyes, protecting the outside from inclement weather conditions, preventing possible theft and theft, and can be adapted to different architectural needs according to the design of the building.

The new design of the Gradmetal 200 model allows it to be integrated into any type of weather it is a renovation, new construction, or glazed surfaces where no protection was not foreseen. SUNON and architects join forces to collaborate and give the best service to their customers.

PHOTOGRAPHIES:

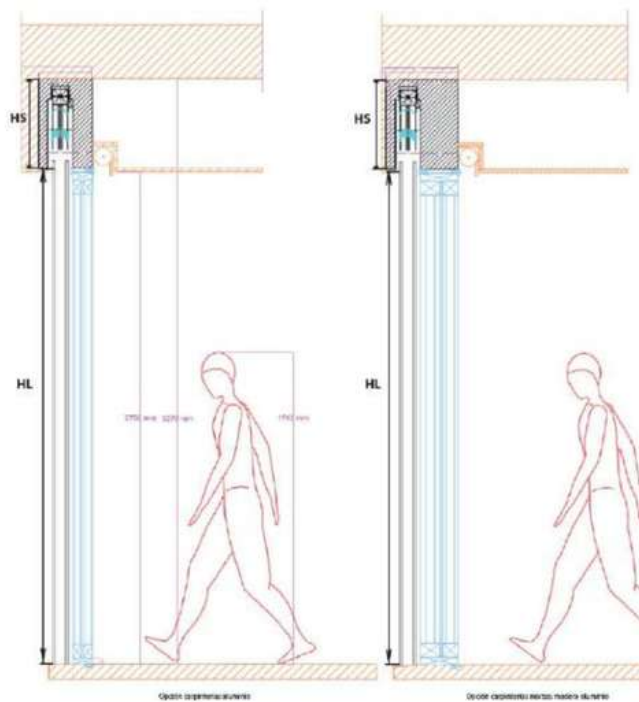

GRADMETAL 200 TECHNOLOGY

DESIGN AND TECHNOLOGY:

The new design of the Gradmetal 200 model and its qualities to adapt to current architecture allows it to be integrated into any type of construction, whether renovation, new construction, or glazed surfaces where no type of protection was foreseen, offering energy value, well-being, light regulation, and natural ventilation.

The aluminum stackable louver with a slat orientation mechanism has a metal folding and maneuvering system incorporated into its slats for greater protection. The new slat supports are enveloping in the inner radius, joining the slat with the support through a stainless steel clip;

the curvature degrees and the thickness of the slat gives it superior stability compared to previous or similar models.

It offers a set of unparalleled features that allow the inclination (37o or 70o) and light regulation from any position of the blind, its quality is certified in marine environments.

This shutter helps to prevent theft in the home or office, as it comes standard with a security locking device: when the shutter is fully closed, it prevents the entry and lifting of the slats from the outside, making it difficult and discouraging thieves.

PHOTOGRAPHIES:



GRADMETAL 200 TECHNOLOGY

PACKAGE MEASUREMENTS:

Aluminio total	Altura de luz	Altura de repliegamiento		Aluminio total	Altura de luz	Altura de repliegamiento		Aluminio total	Altura de luz	Altura de repliegamiento	
VZ	HL	HR	HS	VZ	HL	HR	HS	VZ	HL	HR	HS
500	330	150	170	1680	1397	263	283	2880	2485	375	395
560	382	158	178	1760	1470	270	290	2960	2557	383	403
640	455	165	185	1840	1542	278	298	3040	2630	390	410
720	527	173	193	1920	1615	285	305	3120	2702	398	418
800	600	180	200	2000	1687	293	313	3200	2775	405	425
880	672	188	208	2080	1760	300	320	3280	2847	413	433
960	745	195	215	2160	1832	308	328	3360	2920	420	440
1040	817	203	223	2240	1905	315	335	3440	2992	428	448
1120	890	210	230	2320	1977	323	343	3520	3065	435	455
1200	962	218	238	2400	2050	330	350	3600	3137	443	463
1280	1035	225	245	2480	2122	338	358	3680	3210	450	470
1360	1107	233	253	2560	2195	345	365	3760	3282	458	478
1440	1180	240	260	2640	2267	353	373	3840	3355	465	485
1520	1252	248	268	2720	2340	360	380	3920	3427	473	493
1600	1325	255	275	2800	2412	368	388	4000	3500	480	500

DIMENSIONES MÁXIMAS Y MÍNIMAS

INDIVIDUAL

	MANUAL	MOTOR
Altura luz mínima	0,6 m	0,6 m
Altura luz máxima	4,0 m	4,0 m
Ancho mínimo de construcción (bk)	0,6 m	0,6 m
Ancho máximo de construcción (bk)	2,8 m	2,8 m
Superficie máxima	8 m ²	8 m ²
Número máximo	-	-

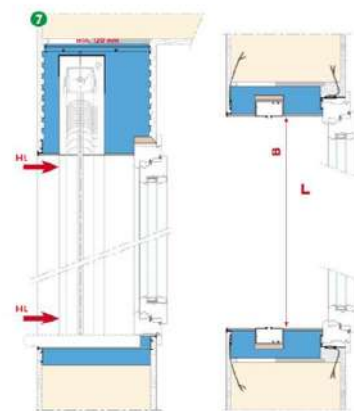

CONTROL AND MANEUVERING SYSTEMS

MANUAL AND MOTORIZED DRIVES:

Manual operation:

Natural anodized aluminum hinged crank handle and gray plastic bracket.

Motor drive:

Induction motor 220V/ 50 Hz depending on the type of motor 0'6-1 '2A of 130-250 W, for single-phase alternating current (domestic lighting), single-phase alternating current (domestic lighting) is incorporated in the support channel and the power connection as required. The Somfy Orienta model is recommended.

The Orienta system simplifies automation through an operator is hidden inside the shutter box, in addition to raising and lowering the shutters, individually or as a group, at any time, the user can orient the slats of the shutters. No specific tools are required for installation or programming.

Automation and centralization:

SUNON advises the Animeo Somfy system which allows the mixed control of push-buttons of any European series or brand and, at the same time, the control and mastery of all Somfy radio systems, especially the transmitters created for models such as MODULIS and IMPRESARIO as well as all the compatibility in wind-sun, rain, and temperature sensors.

The new YESSEO system allows the interconnection of all the models that SUNON has and the control of different brands such as VELUX, HORMAN, HONEY WELL, etc.



ADVISE AND BINOMIALS

SUNON DRAWERS & GRADMETAL 200 SHUTTERS

For a correct pre-installation and easy assembly of the shutter, it is advisable to have a Stabil box that complies with the standards of the Technical Building Code. The Stabil box model for Gradmetal 200 uses a patented system that offers excellent thermal and acoustic qualities with a certificate of more than 40 decibels.

Its system of thermal panels and its design achieve maximum stability and the plus of modularity to different exterior and interior sizes as required. This system does not require interior registers or exterior covers, achieving unbeatable aesthetics and comfort.

It has exterior finishes made of high-density polyurethane and Heraklit plates, which provide better adhesion to subsequent coatings or plaster.

The combination of applicable or retractable shutters with **SUNON** tunnel boxes facilitates preparations for window installers and builders.

SUNON, in collaboration with architects, designs installations where this system allows the pre-installation of mosquito nets or screens between the glass and the Gradmetal 200 shutter, saving space, design, and future costs.

PHOTOGRAPHIES:



SOLAR SHADING SYSTEMS FOR CURTAIN WALL FACADES OR SLIDING WINDOWS

SUNON DYNAMIC FAÇADE

One of the most important materials in modern architecture is glass. Glass seduces by its transparency and achieves elegant architectural solutions with a modern and light line, although its use as an envelope in facades is extremely delicate in several ways and depending on orientation or geographical area can present very high energy costs and little comfort to users.

Sunon has designed several exterior solar protection systems, ideal for improving energy savings, and where the user can have dynamic elements that adapt at all times to the weather outside and get the best performance of all types of glass facades or curtain walls already existing.

The different possibilities and models we offer require a technical and energetic study, which can even determine in new projects, the initial savings in the choice. The use of more expensive special glass and the reduction of power for air-conditioning machines.

Sunon Dynamic Façade is the result of combining optimal exterior solar protection systems for glazed facades, which, by means of sensors and an intelligent control system, adapt to constant changes in temperature and luminosity according to the time of day or season of the year.

This management is programmed according to occupants' needs and building typology and can be interrelated with protocols and parameters of the other climate and lighting installations. The efficiency and experience after monitoring several buildings installed all over Spain with the Sunon Dynamic Façade systems are managed by Sunon Dynamic Façade.

Sunon Dynamic Façade systems managed with the Animeo control system are the best proof and support for the following presentation.

PHOTOGRAPH:



GRADMETAL 200 STRUCTURAL SYSTEM

DESIGNED TO COVER LARGE SURFACE AREAS

A self-supporting system that allows the creation of a double façade where all the mechanisms that allow folding, orientation, or total closure are metallic.

The 2.2 mm thick extruded aluminum structural mullions and their geometry allow for reinforcements or joints in the inner chamber of the profile, which allows reaching heights of up to 7400 mm without intermediate anchors and coupled structures higher than façades of 30 meters in height and 500 m² of surface area. In large façades where adjustable brackets and anchors are used, the possibility of optional fixing of lifelines has been taken into account and strict tests of mechanical resistance and wind loads have been carried out mechanical strength and wind loads.

Once the structure has been completed, the louver guides in the external housing provided, giving even greater robustness to the set.

Sunon integrates the Gradmetal 200 folding shutter model for its aerodynamic design of slats, enveloping type of support, maximum resistance in the stainless steel clip fixing and the high quality of its mechanisms recognized throughout Europe.

Depending on modulation and cubic capacity, we have the option of using profiled or extruded louvers.

In singular façades or office areas, we have the Structural Gradmetal 200 inverted system, where the entire louver set is deployed from bottom to top, so the user can screen a part of the window to avoid reflections in the interior, and at the top, allowing the full entry of natural light.

PHOTOGRAPHIES:



SISTEMA ESTRUCTURAL GRADMETAL 200

ADVANTAGES

Unlike other facades such as lattices, Briseleil, or visors where there is only sometimes the possibility of orienting the louvers a few degrees, and the entire facade always remains occupied, prohibiting for example in winter the full use of solar radiation or a clear and complete view of the outside.

The windows or glass enclosures are the bridge between the exterior/interior solutions we

provide your facades with dynamic envelopes that adapt to the climate, and acoustics, facilitate natural ventilation of all types of buildings and enclosures, and facilitate natural ventilation of all types of buildings and enclosures. The solutions we propose are ideal to provide your facades with dynamic envelopes that adapt to the weather, and acoustics and facilitate the natural ventilation of all types of buildings and enclosures.

DIAGRAMS:

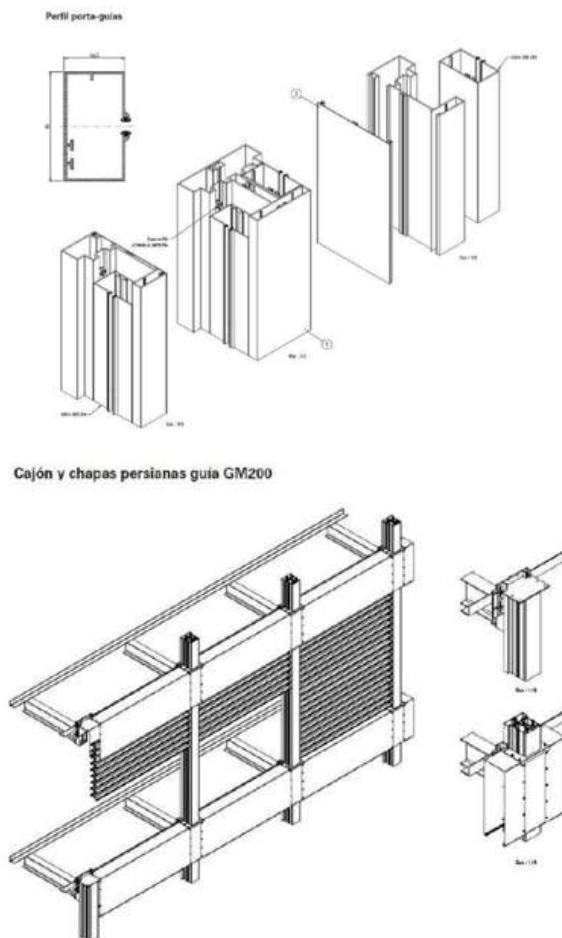

Soporte regulable perfil

